

9

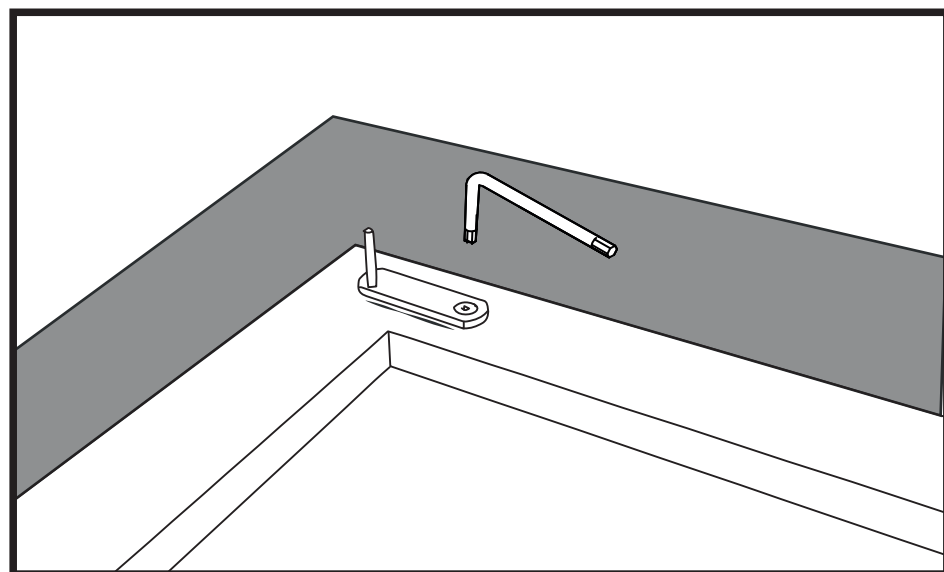

10

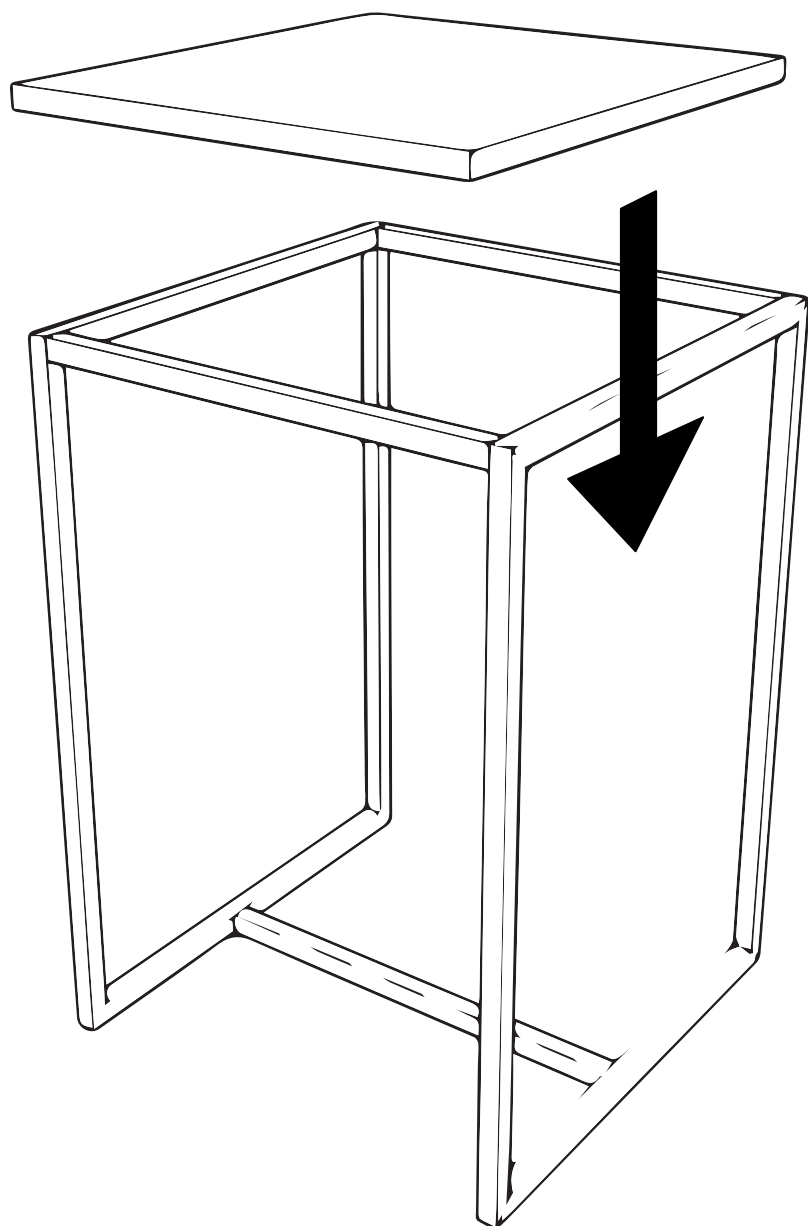

# PERSPECTIVE

Bartable - Table de bar

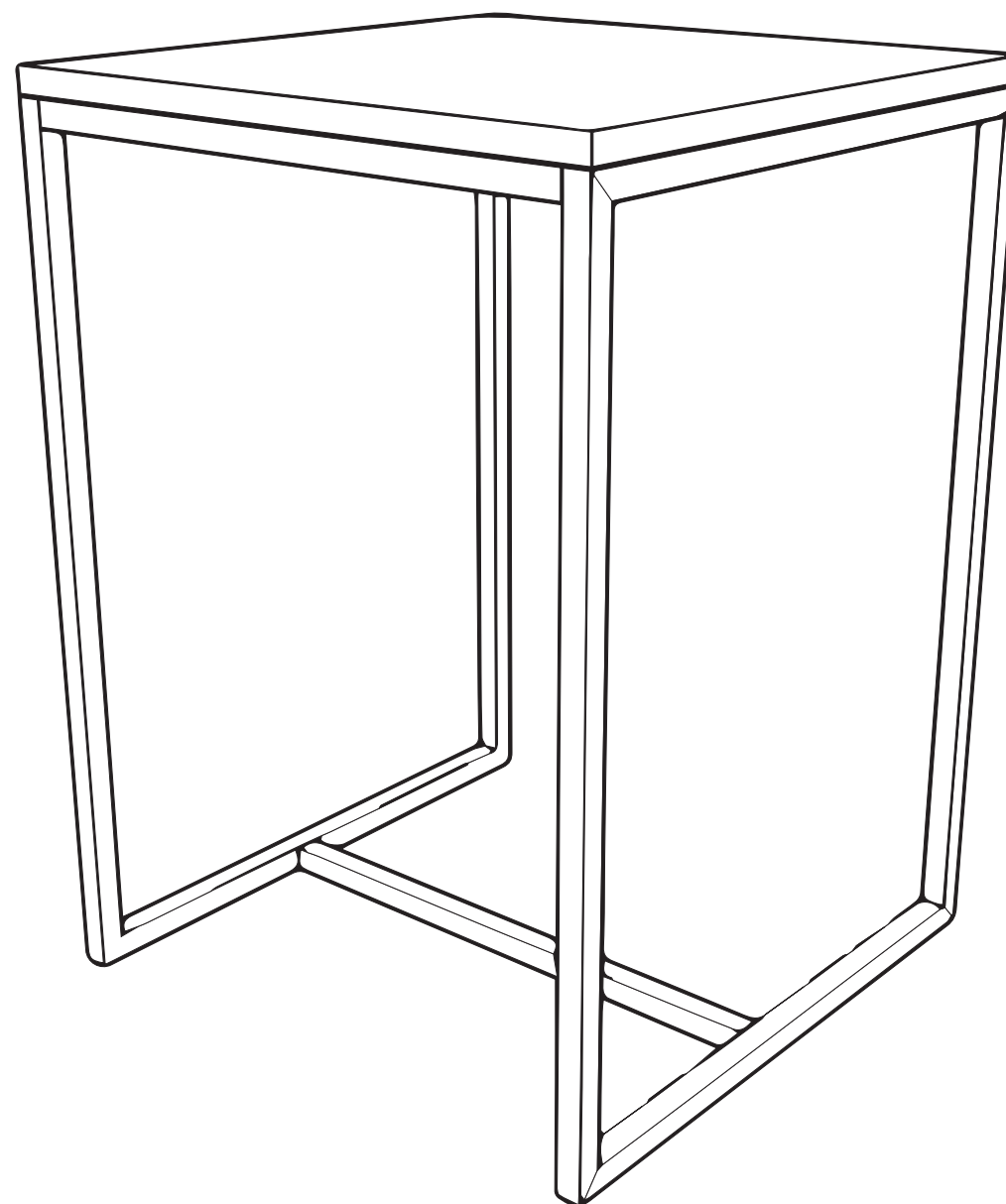

## GENERAL COMMENTS

Carefully read the instructions before processing.

Identify the different parts of the product and keep the area clear before you start assembling.

The assembly should be done by a qualified person as a wrong assembly may lead to damages or personal injury.

Keep these assembly instructions for future reference as it could facilitate communication with your dealer, in the event of any inquiry.

## DISTINCTIVE FEATURES

The article is hand-crafted and made with light-concrete composed with natural elements (cement, sand, water, steel, and fibres).

The pores, micro-cracks and possible variations in colour are inherent characteristics of the material used. Which gives to this furniture its unique appearance and charm. For those reasons, this article cannot be returned or exchanged.

## MAINTENANCE AND CARE

Our products are treated with water and oil proof sealers but stains should be wiped rapidly with a wet sponge and soft soap.

Never use abrasive products, strong acid detergents, bleaching agents, metal brushes, or high-pressure cleaners. Preferably use a soft clean dry cloth.

For good protection, apply wax or stone preserve products regularly.

# 7

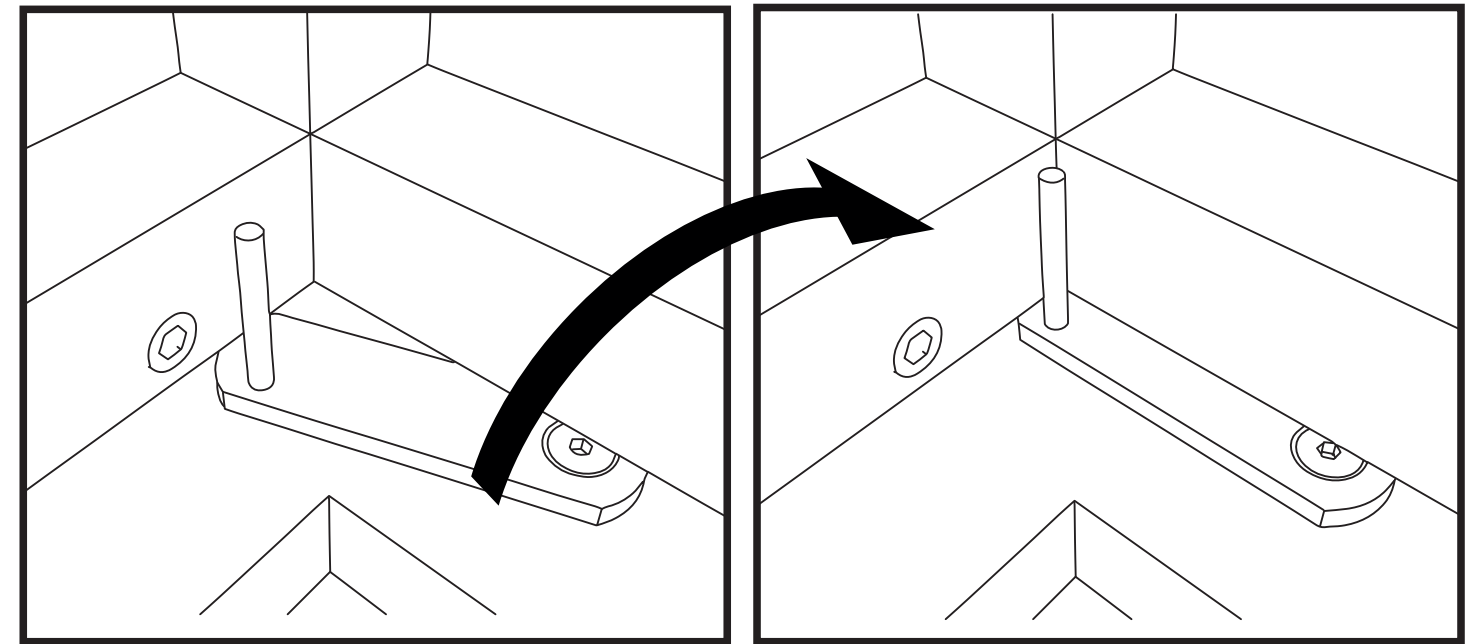

# 8

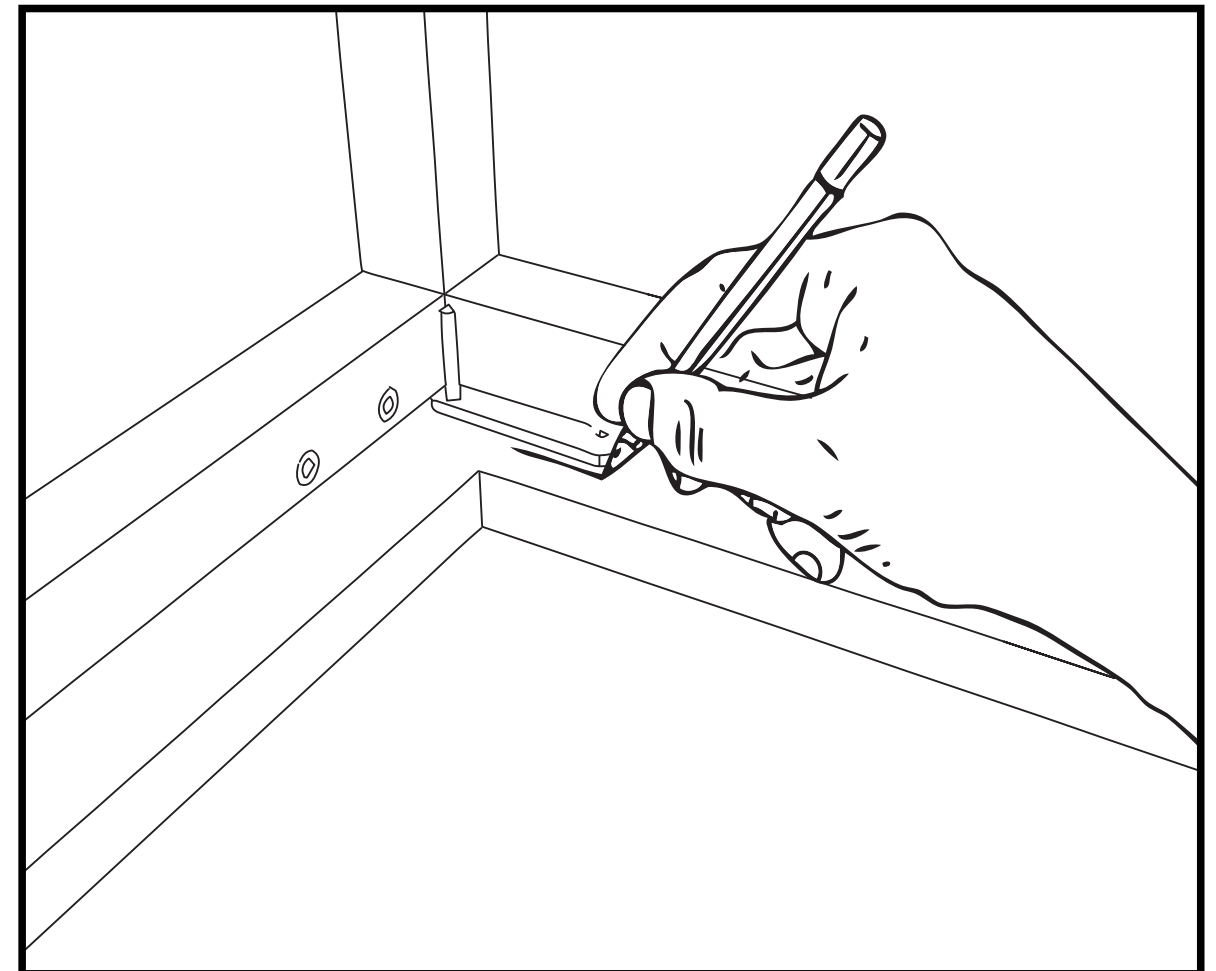

# 5

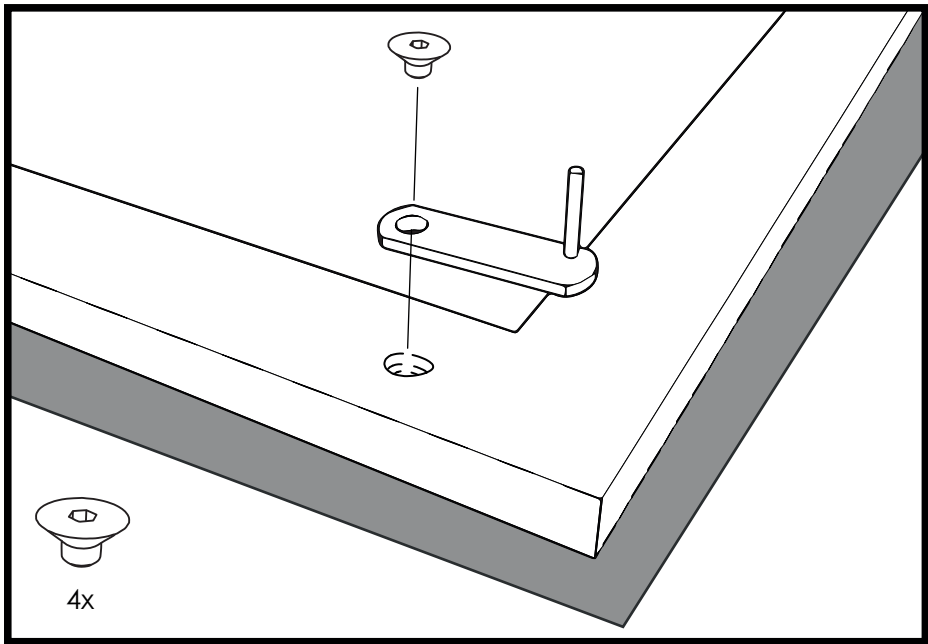

Assemble upsidedown on a soft surface  
i.e. on a carpet, on the plate carton box / polyfoam sheet.

# 6

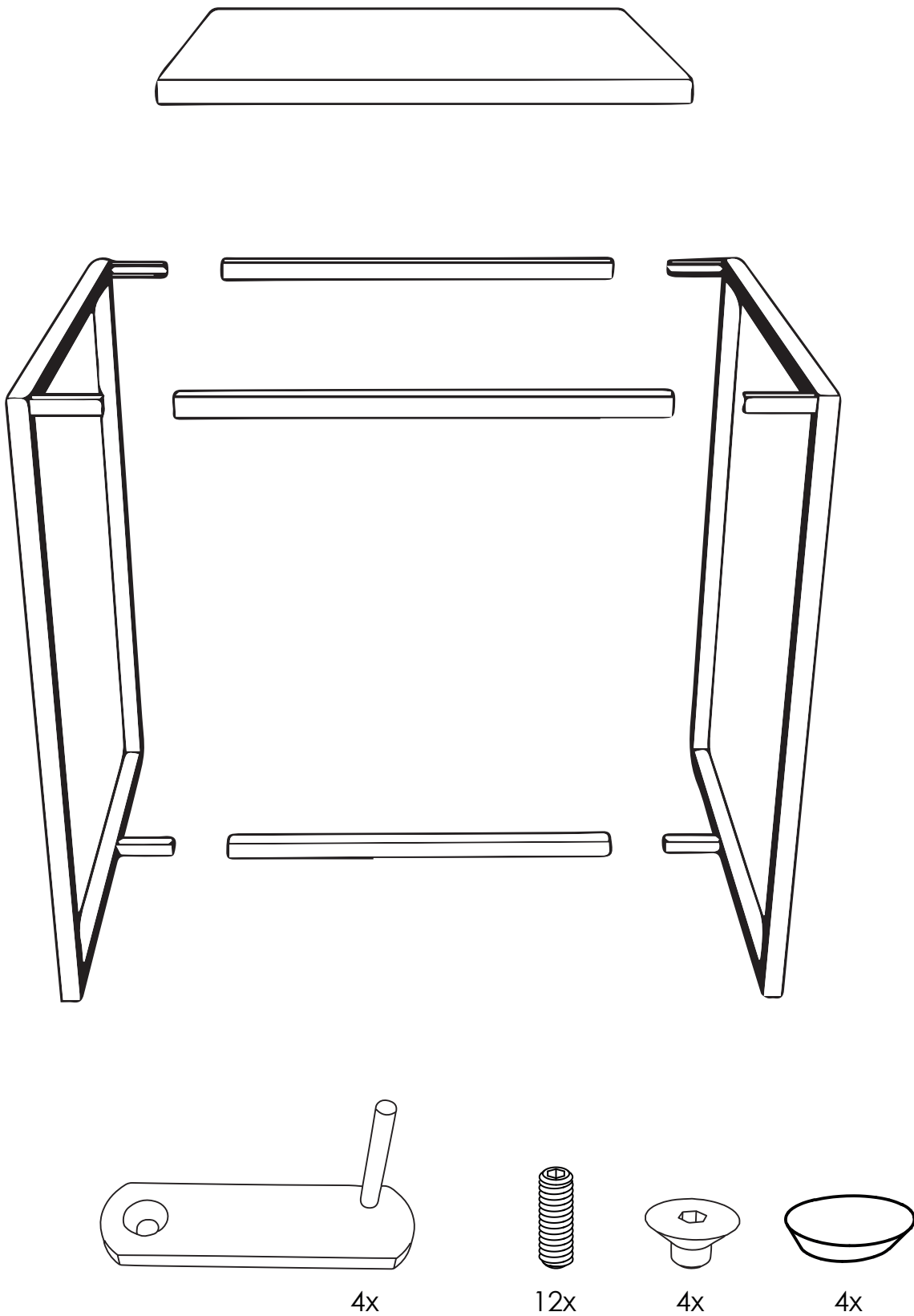
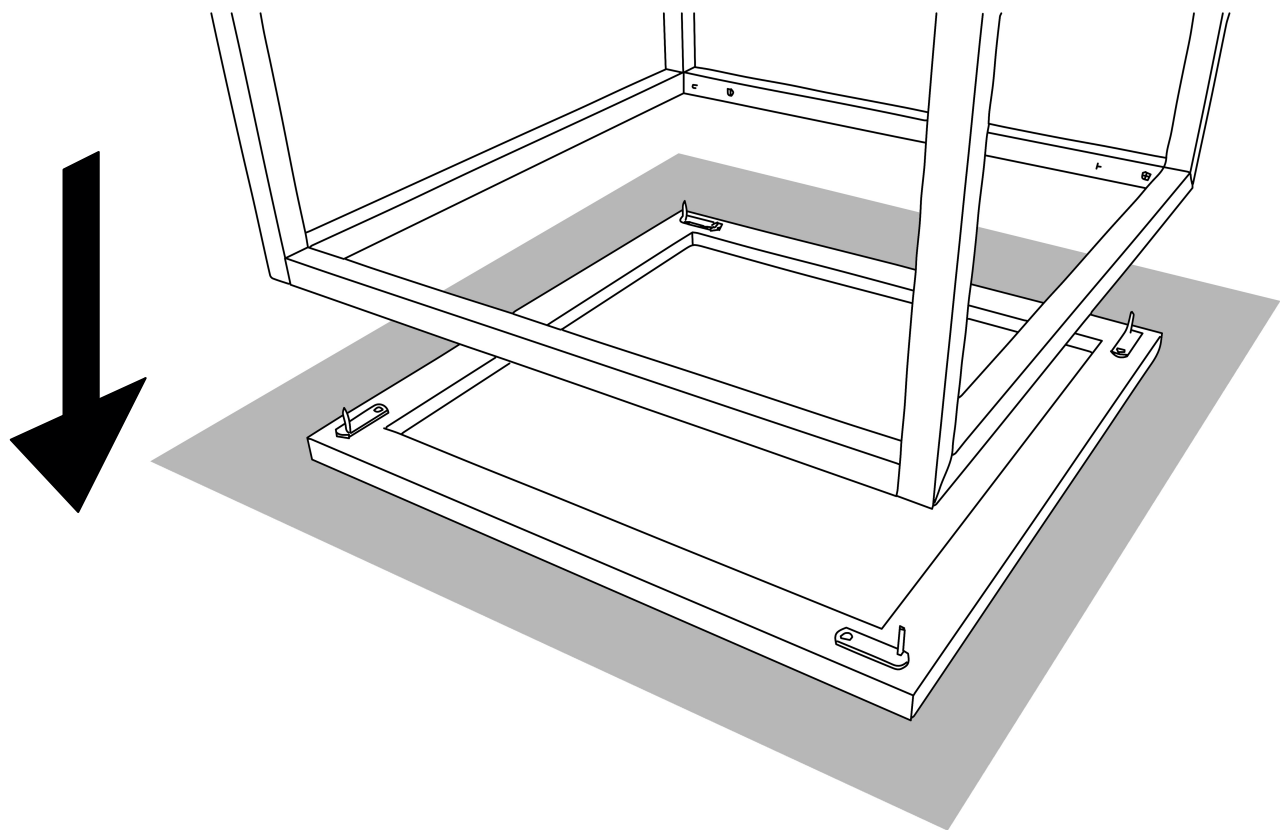

1

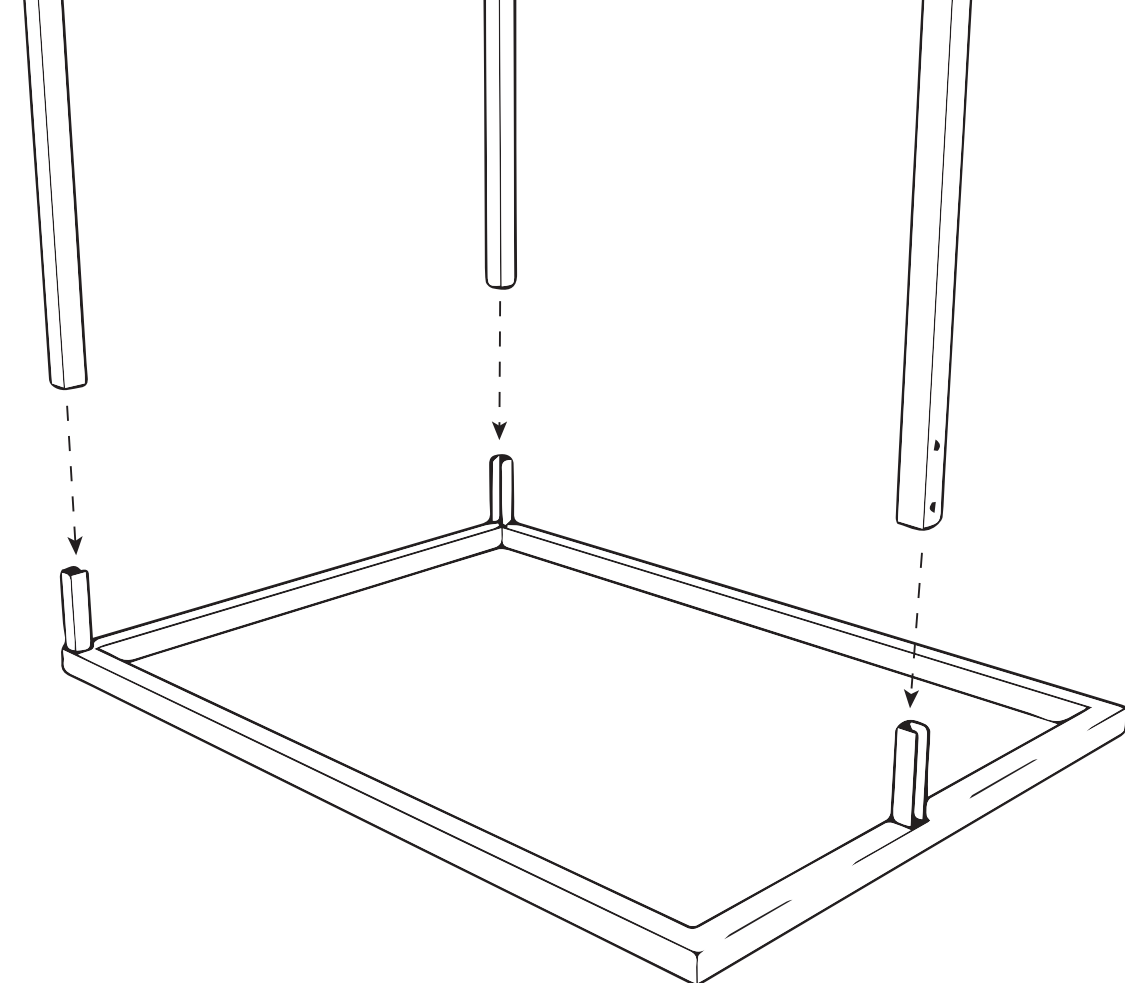

2

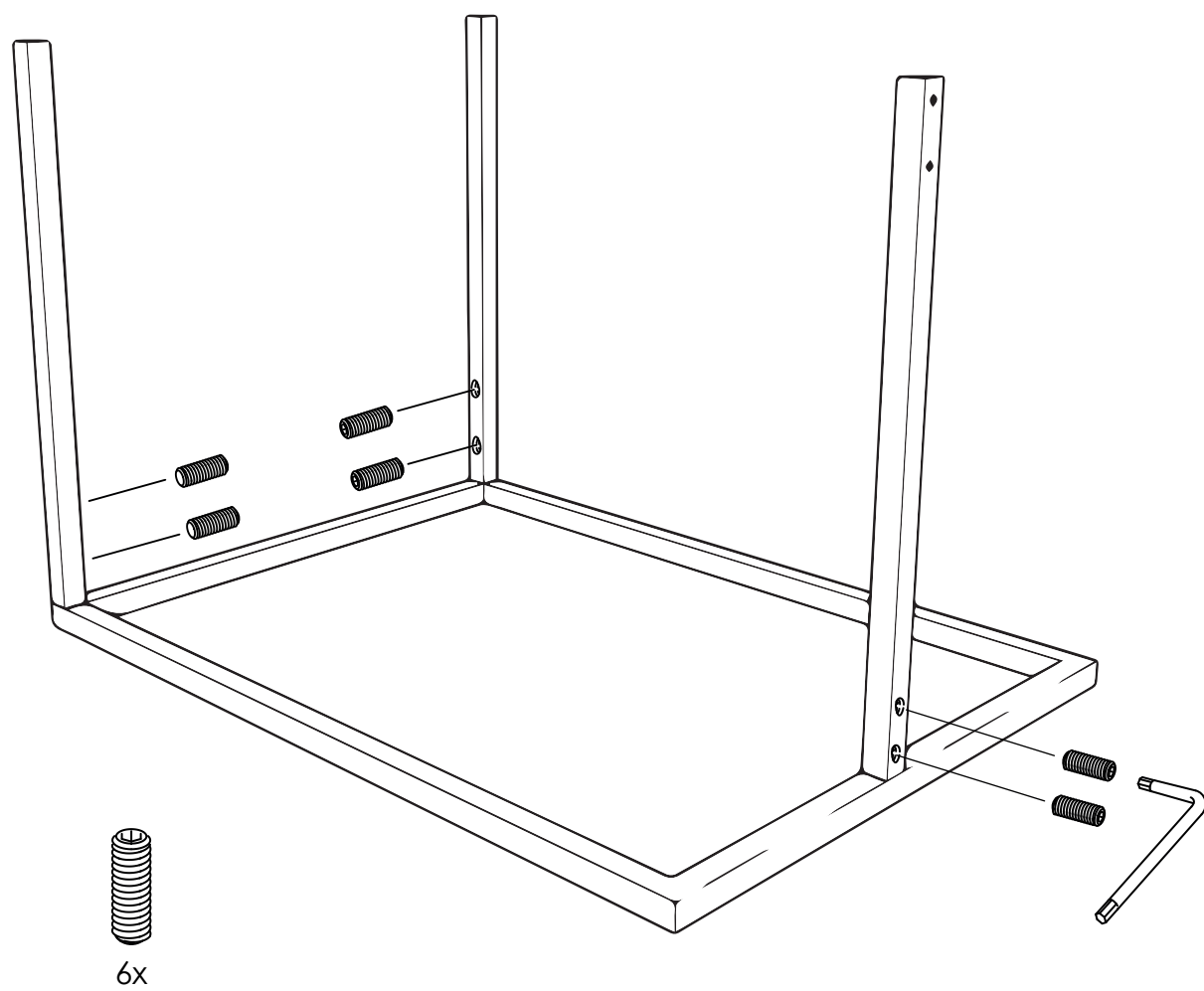

3

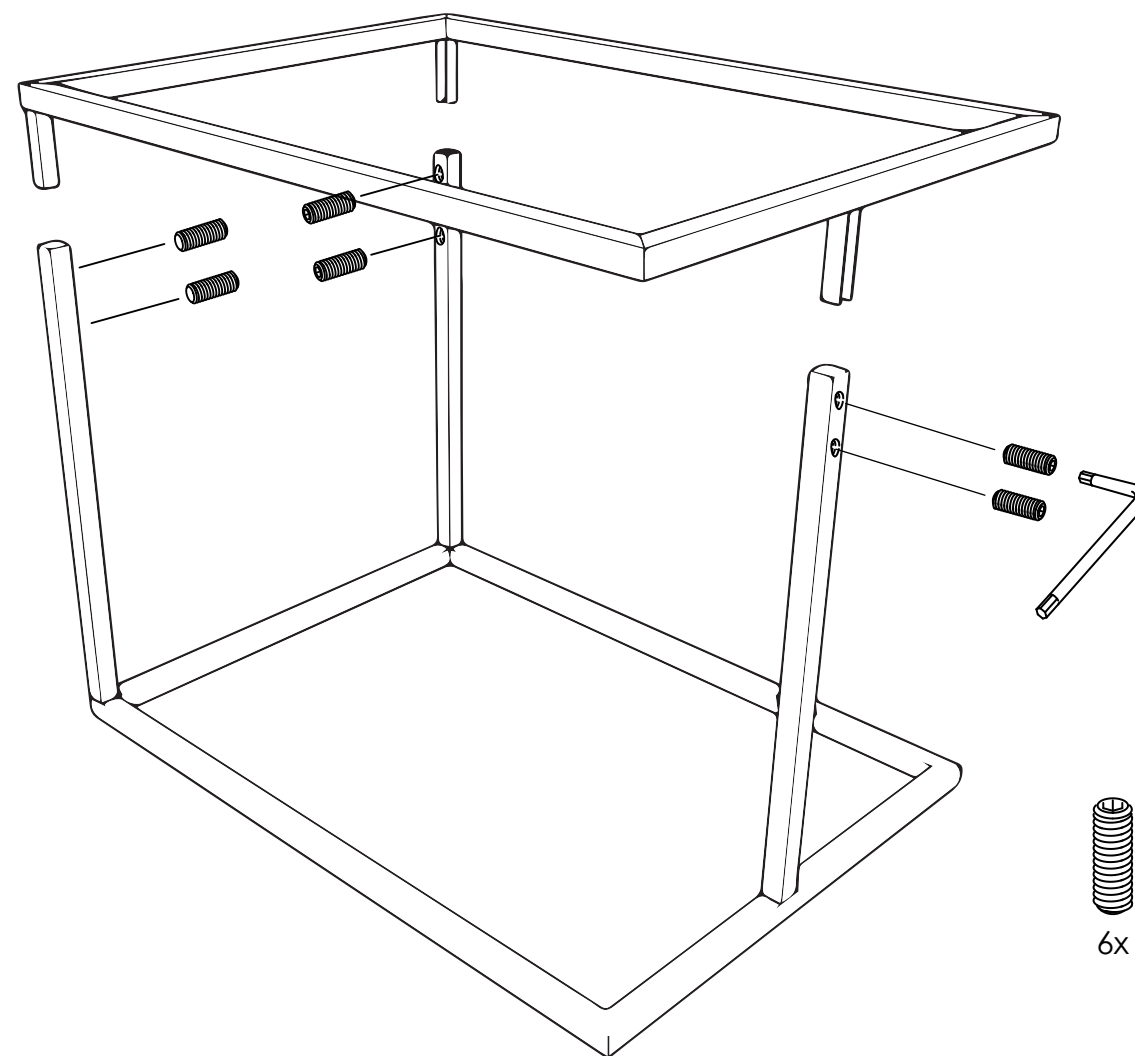

4

